

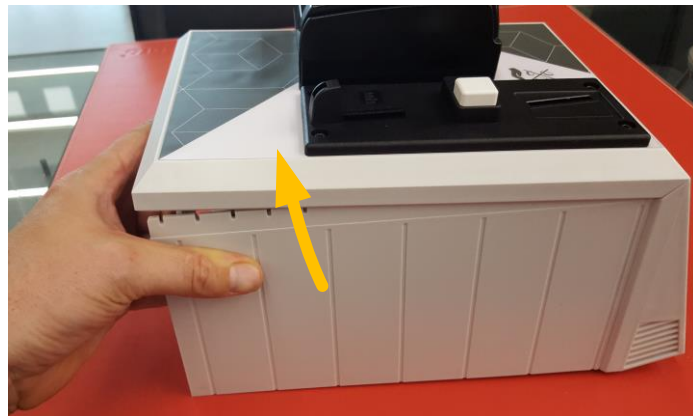

Step 1: Open SKUARIO Box coin storage with key

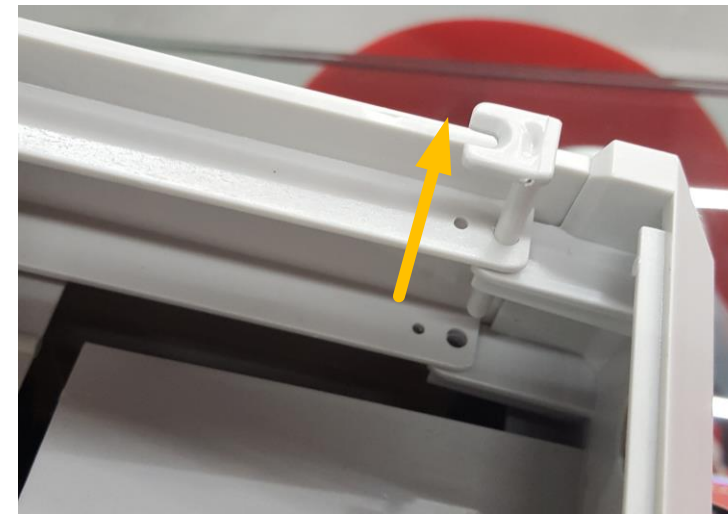

Step 2: Remove the lock pins from the bottom of the SKUARIO Box



Step 3: Open the front of the box to an angle of 15° - 20° degrees

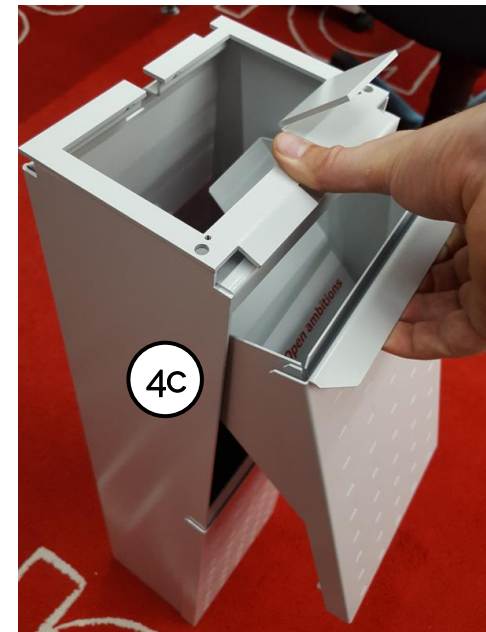
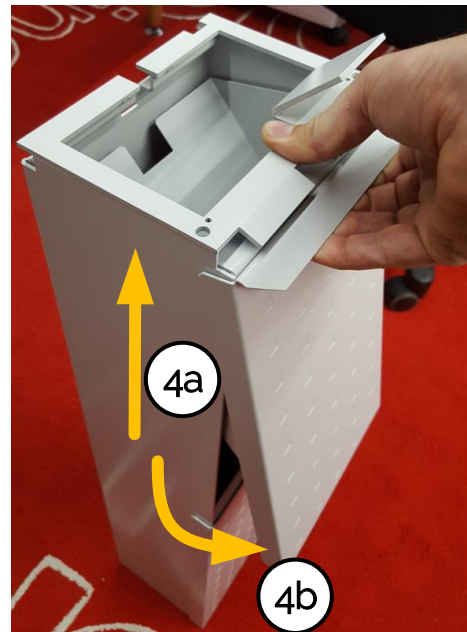

Step 4a: Lift up the money tray
Step 4b: Rotate the money tray bottom-forward
Step 4c: Remove money tray



Step 5: Mount the SKUARIO Box on the pillar and close the front lid again



Step 10: Finished: SKUARIO Box mounted

Step 6: Take a position so you can view the bottom of the SKUARIO box via the money tray opening at the front.

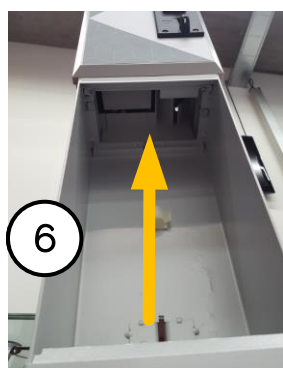

Step 7: Attach the clips

Step 8: Place the lock pins back in the SKUARIO Box

Step 9: Secure the lock pins with the SKUARIO Box screws

